

Gas scrubber



Application

Decentralised solution for eliminating acid and base residues from emissions into the atmosphere from fume cupboards. Its compact design allows the scrubber to be incorporated into the top part of the fume cupboard, cleaning the effluent at the point of emission. Gases pass through the suction nozzles, to the absorption chamber where the diffuser pump is located, which draws wash water from the bottom of the integrated tank and through injectors, causing a dense fog in the absorption chamber. In this way, an optimum mixture of harmful gases with wash water is obtained and, as a consequence, very efficient absorption. The wash water level is regulated by means of floats. The wash water is replaced automatically by the equipment itself.

Models



1. C54 and C90



2. C180

Drawings

C54 and C90

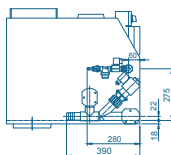
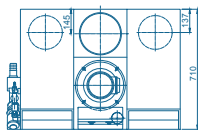
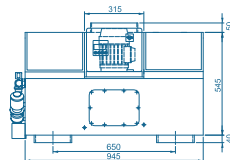

C180

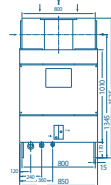
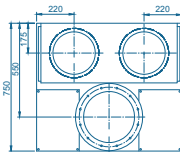

Technical characteristics

	C54 gas scrubber	C90 gas scrubber	C180 gas scrubber
Layout	Installation in the top part of the fume cupboard.		Beside the fume cupboard or
Materials used (parts in contact with effluent)	Housing and spray wheel: Polypropylene; Accessories: PVC-U; Joints: EPDM / PTFE.		
Ventilation			
Flow rate (m ³ /h)	480-900	600-1.400	600-1.800
Pressure loss (Pa)	200-530	260-1.140	160-1.020
Air intake	2 DN 200 tubes (lower part)	2 DN 200 tubes (lower part)	DN 250 flange
Air outlet	1 DN 250 tube	1 DN 250 tube	1 DN 315 flange
Dimensions and weights			
Width (mm)	950	1220	850
Depth (mm)	710	710	750
Height (mm)	550	550	1535
Volume of water (l)	45	60	70
Weight (empty) (kg)	90	110	120
Total weight (kg)	135	170	190
Water connections			
Power supply	DN 10	DN 10	DN 10
Outlet	DN 32	DN 32	DN 20
Overflow	DN32	DN 32	DN 32
Inspection			
Inspection cover	2	2	2
Front inspection window	Yes	Yes	No
Electrical control			
Control unit	Plastic housing with programmable logic controller (PLC), switching unit for the spray wheel motor, operating mode selector switch, repair switch, plug-in connector for accessory operating module with membrane keypad.		
Power supply	Three-phase 400/230 Volt, 50 Hz, 3L/NE/PE, 0.55 kW. Connection by means of quick connect couplings.		
Level control	2 level switches for minimum and maximum fill level.		
Sanitary equipment	1 solenoid valve with dirt collector and manual ball valve, 1 outlet solenoid valve.		
Change of flushing fluid	Time-dependent control, times can be set within a wide range, optionally by means of a conductivity measurement.		
Optional accessories	Probe with integrated measuring amplifier for measuring electrical conductivity, preheating unit for flushing liquids. Additional accessories in the corresponding chapter.		
Protection type	IP 54 motor, IP40 back rear control unit, IP54 front with closed hood.		